

# ASSEMBLY INSTRUCTIONS

Read this instruction carefully. See hardware and furniture part list for guidance. Be sure all parts are complete, before you assemble. Place all wooden furniture parts on a clean and flat soft surface to prevent from being scratched. Follow the figure to start assembling.

- CAUTIONS :**
1. Do not FULLY - TIGHTEN the nut or nut bolt until all nut or bolt is ready assembled.
  2. Do not OVER - TIGHTEN the nut or bolt to avoid causing damages to the thread.
  3. Keep all hardware parts out of reach of children.

**NOTE :** THE LIST AND QUANTITY SHOWN ARE FOR 1 UNIT ASSEMBLY.

Tool needed : Screwdriver & Rubber Mallet (not provider).

PART LIST		
ITEM	DESCRIPTION	QTY
A	ARM (LEFT)	1 PC
B	ARM (RIGHT)	1 PC
C	SIDE RAIL (BACK)	1 PC
D	SIDE RAIL (FRONT)	1 PC
E	BED SLAT	26 PCS
F	CENTER RAIL	1 PC
G	CENTER SUPPORT LEG	3 PCS
H	CENTER SUPPORT	2 PCS
I	BACK REST	1 PC

HARDWARE LIST		
ITEM	DESCRIPTION	QTY
1	BED SLAT SIDE FITTER	26 PCS
2	BED SLAT CENTER FITTER	13 PCS
3	JCBC BOLT M6 x 50mm	4 PCS
4	M6 FLAT WASHER	4 PCS
5	WOOD DOWEL M8 x 30mm	2 PCS
6	WOOD SCREW M3.5 x 16mm	8 PCS
7	WOOD SCREW M4 x 20mm	2 PCS
8	M4 ALLEN KEY (BALL SHAPE)	1 PC
9	M5 ALLEN KEY (BALL SHAPE)	1 PC

## STEP 1

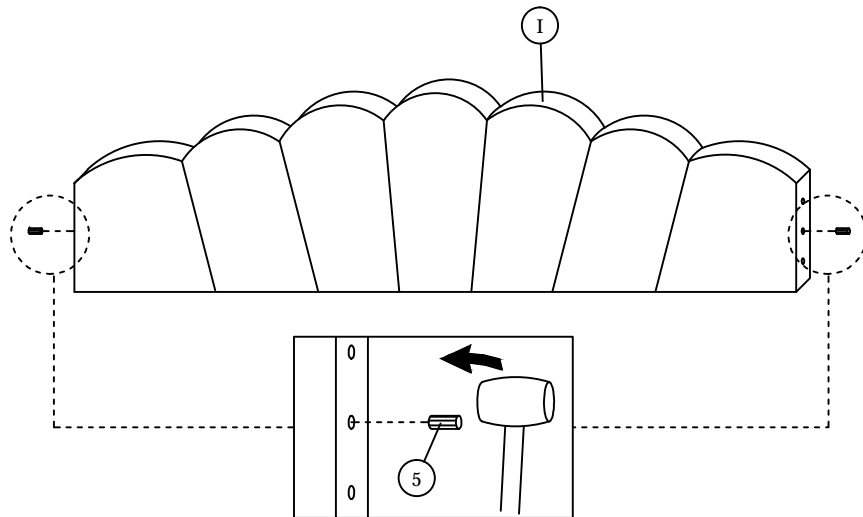

## STEP 2

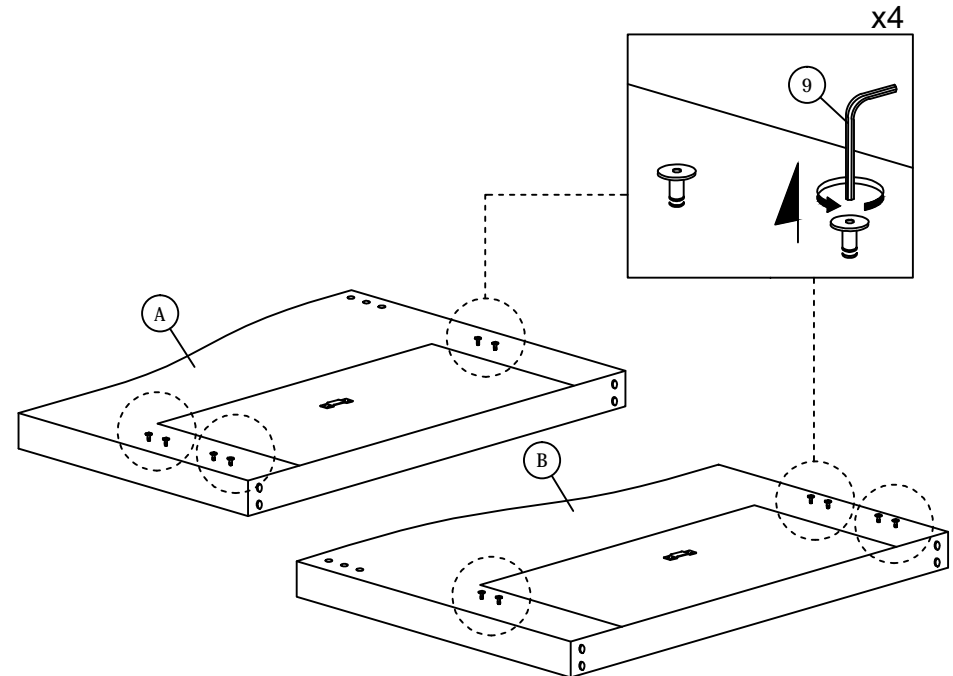

# ASSEMBLY INSTRUCTIONS

## STEP 3

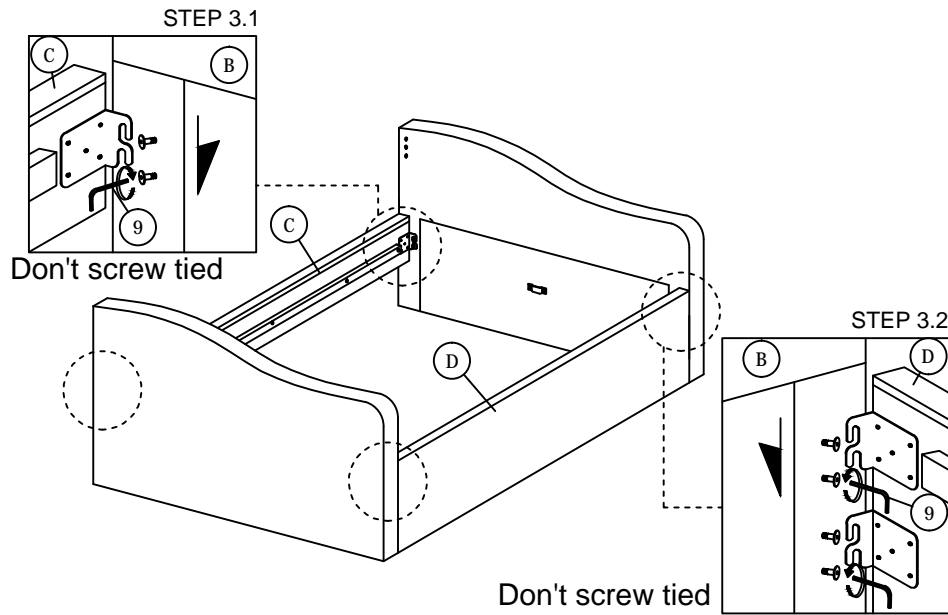

## STEP 4

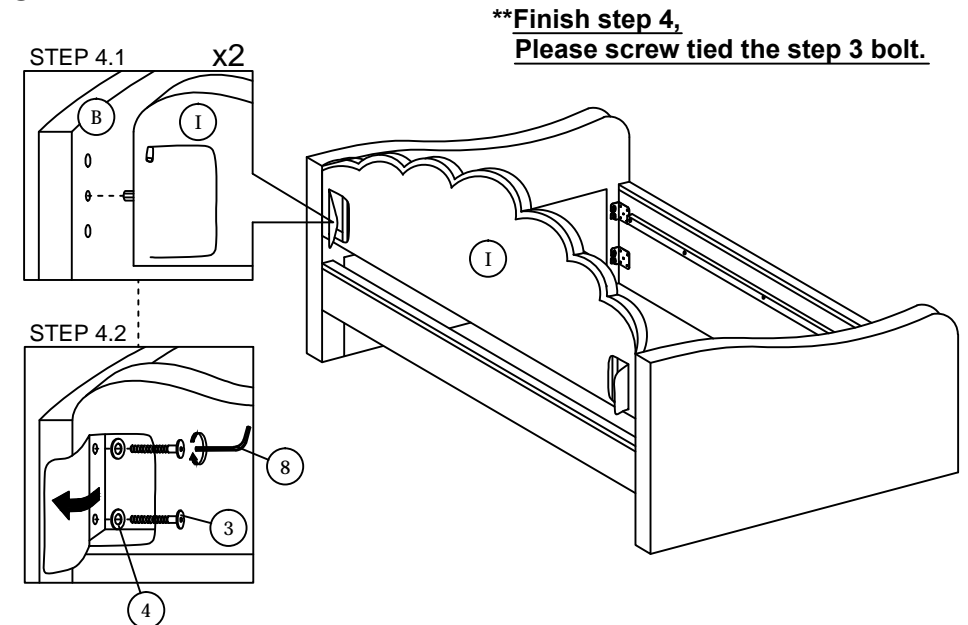

## STEP 5

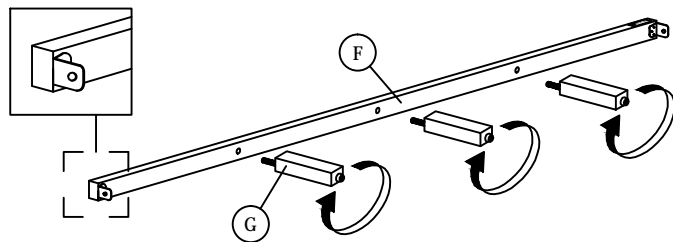

## STEP 6

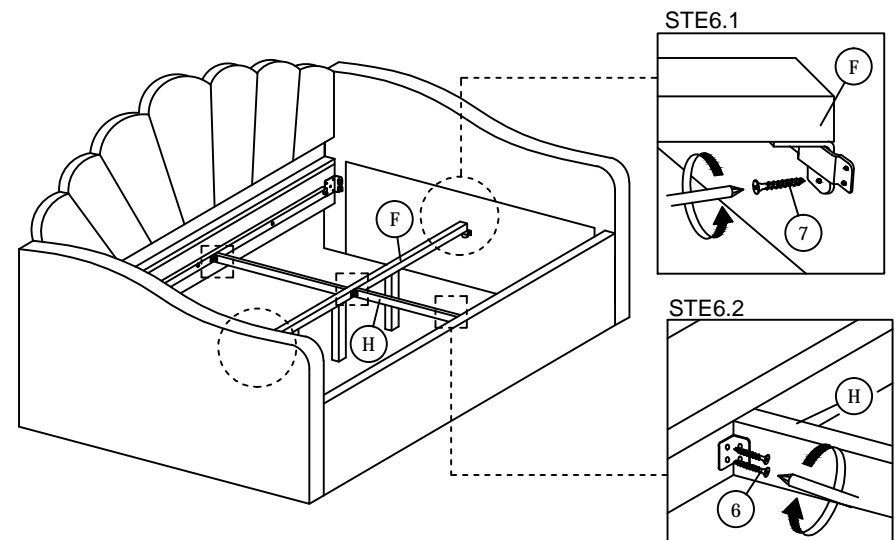

# ASSEMBLY INSTRUCTIONS

STEP 7

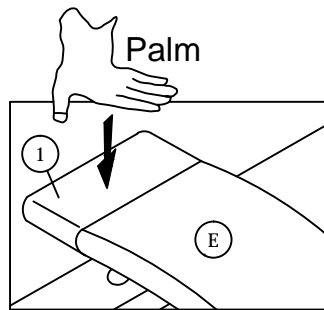
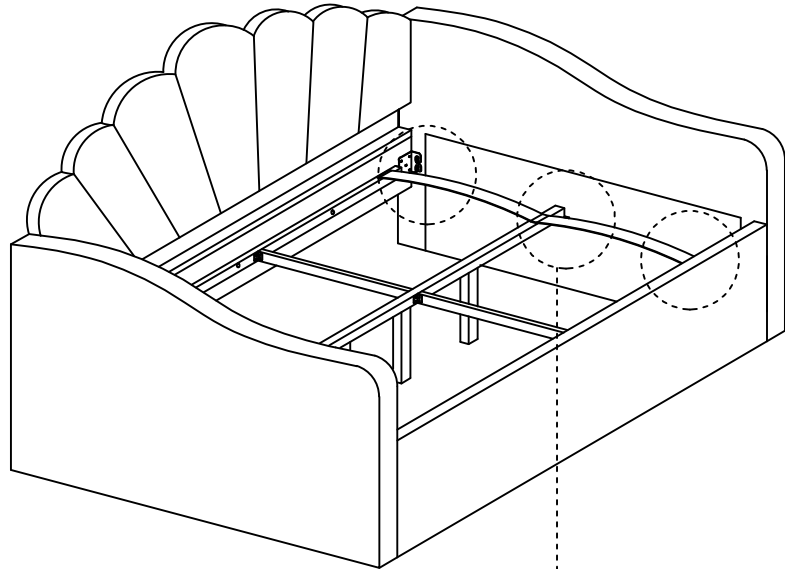
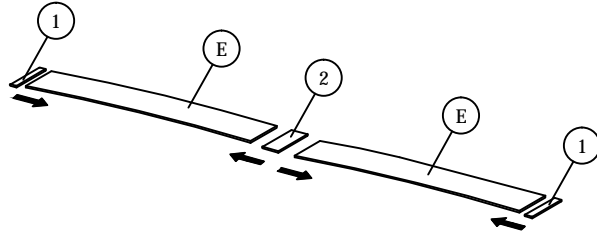

STEP 7.2

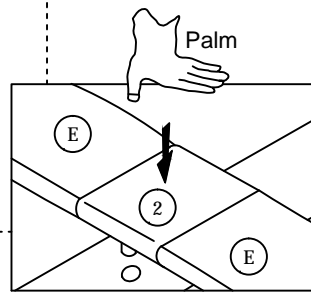

STEP 7.1

STEP 8

